

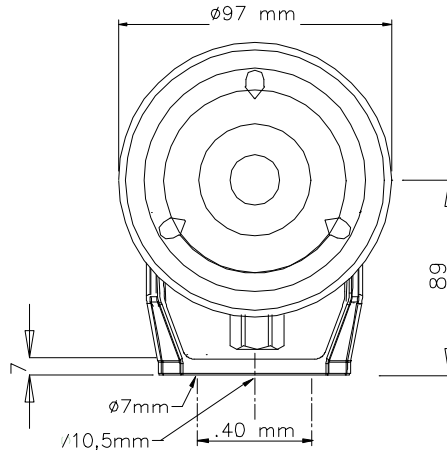

ISO 9001 CERTIFIED

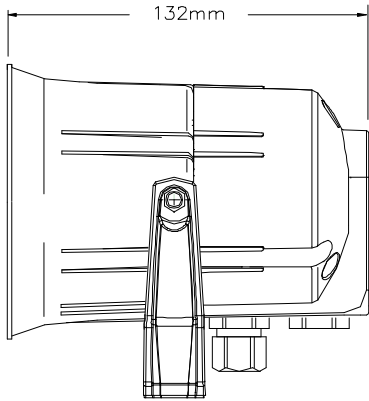

Transformer:
100 V line (optional 70V, 50V)

Primary nominal tapings:

- 1 : 2 6,0 W
- 2 : 3 3,0 W
- 3 : 4 1,5 W
- 1 : 3 1,0 W
- 2 : 4 0,6 W
- 1 : 4 0,4 W

- 1 = Red, 2 = Yellow
- 3 = Green, 4 = Blue

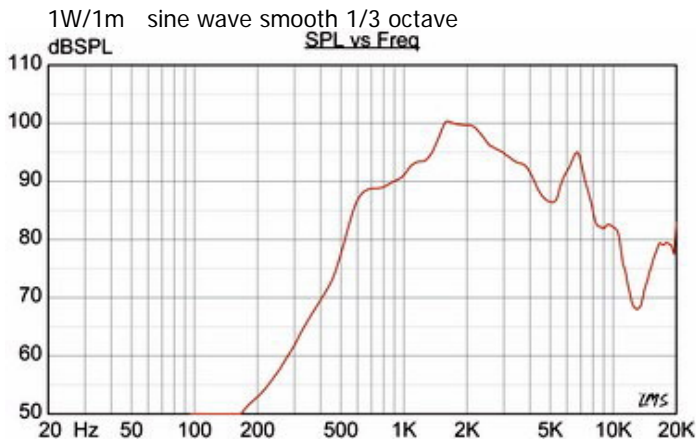

- Material / Color Polyamide UL94 V0 / RAL 7035
- Mounting Bracket
- Termination Internal screw connections
- Weight w/ transformer 0,8 kg
- IP-rating (UL equivalent) 67
- Max / min amb temp 90 °C / -40 °C
- Rated / max power 6 W / 15 W
- SPL 1W/1m 100 dB
- SPL rated power 107 dB
- Effective freq range 500 – 7500 Hz
- Dispersion (-6dB) 1kHz / 4kHz 170° / 70°
- Options Impedances, colors, labels

Installation, Operation and Maintenance Procedures

- Remove lid to connect to terminal (HP-6C) / or connect cable into a suitable junction box (HP-6CT).
- Fasten bracket with 2 screws.
- To change the position of the loudspeaker, please adjust the bracket (by loosening / tightening the screws) as required.
- For optimum performance, always use the correct voltage / power and operate within the frequency limits as stated.
- Fasten lid with a torque of 1 - 2 Nm (HP-6C only).
- This loudspeaker is supplied with a 2 year warranty against defective materials and workmanship.

